



Newcastle East End

Visual Impact & Street View Analysis - Hotel Building B, Stage 1

View Impact Analysis

The following pages outline the view impact analysis of the Concept Proposal. The following views have been selected which are relevant to the proposal for Building B.

They include:

- 1. Wharf Road, opposite Perkins St facing south east
- 2. Perkins Street: corner of Hunter and Perkins Streets, facing south
- 3. Hunter St, between Perkins & Brown St facing East
- 4. Hunter Street: between Perkins and Wolfe Streets, facing west
- 5. Corner of Hunter and Perkins Streets, facing east
- 6. Perkins Street: corner of King and Perkins Streets, facing north
- 7. Perkins Street, between King and Church Streets, facing north
- 8.Cathedral Park, looking Northwest
- 9. Cathedral Park, looking Northwest
- 10. Catherdral Park to Throsby Basin
- 11. Griffith Park, Stockton

THE SITE

← 1

DCP SIGNIFICANT VIEWS

← 1

ADDITIONAL VIEWS

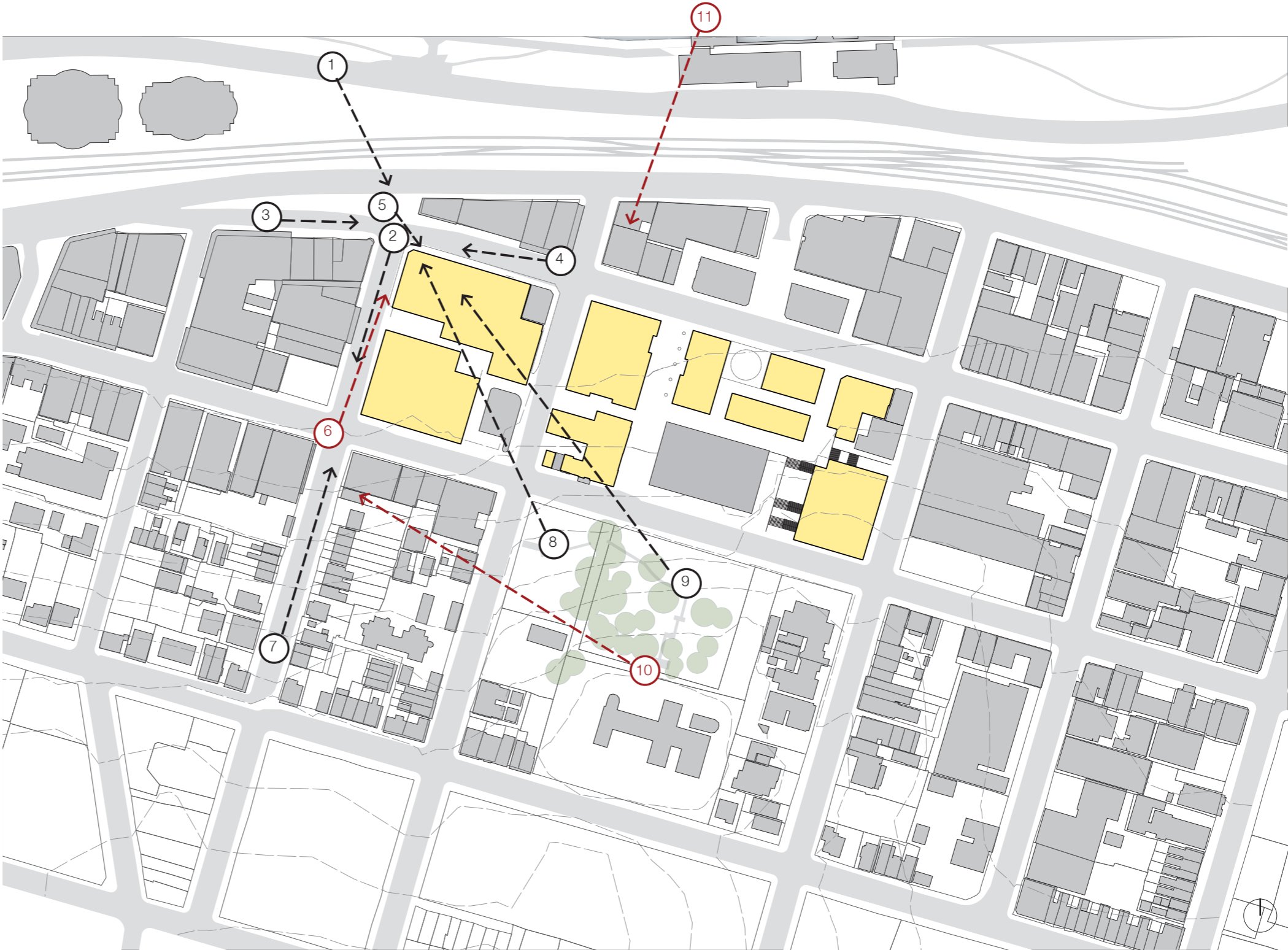

Wharf Road opposite
Perkins Street

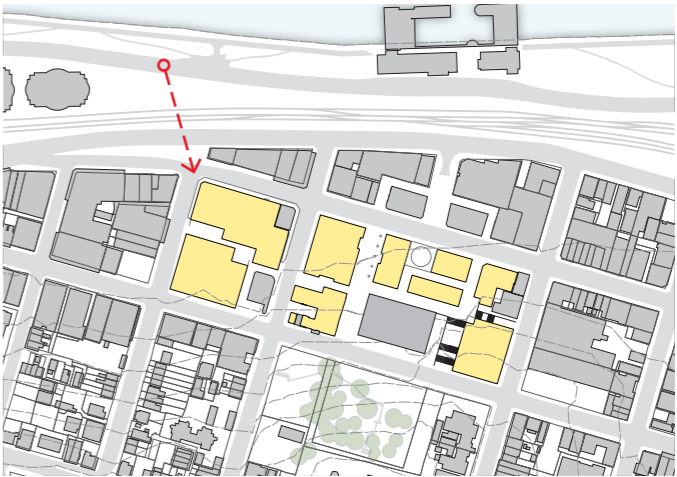

- APPROVED DA
- PROPOSED ADDITIONS TO BUILDING B

Perkins and Hunter
Street intersection



- APPROVED DA
- PROPOSED ADDITIONS TO BUILDING B

Hunter St, between Perkins
& Brown St facing East

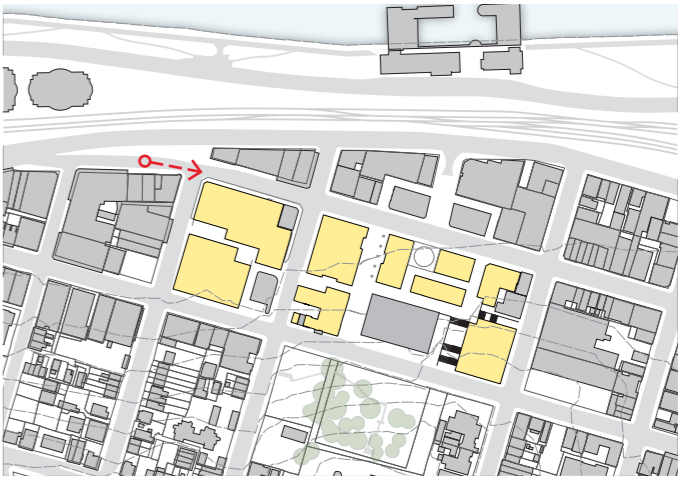

- APPROVED DA
- PROPOSED ADDITIONS TO BUILDING B

Hunter St between
Perkins and Wolfe St

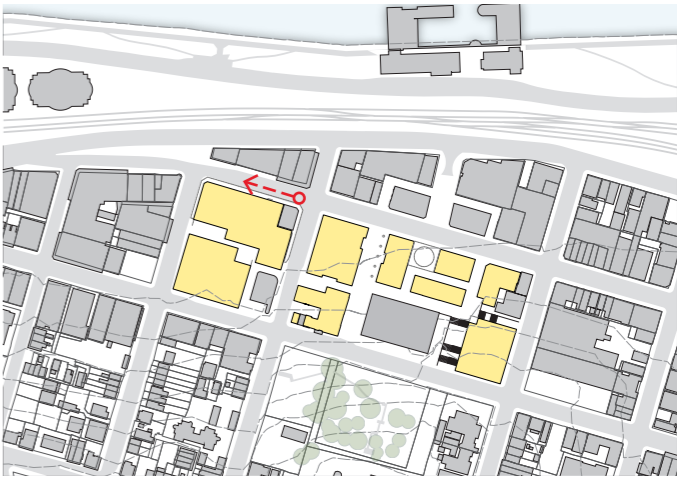

- APPROVED DA
- PROPOSED ADDITIONS TO BUILDING B

Corner of Hunter &
Perkins St facing East

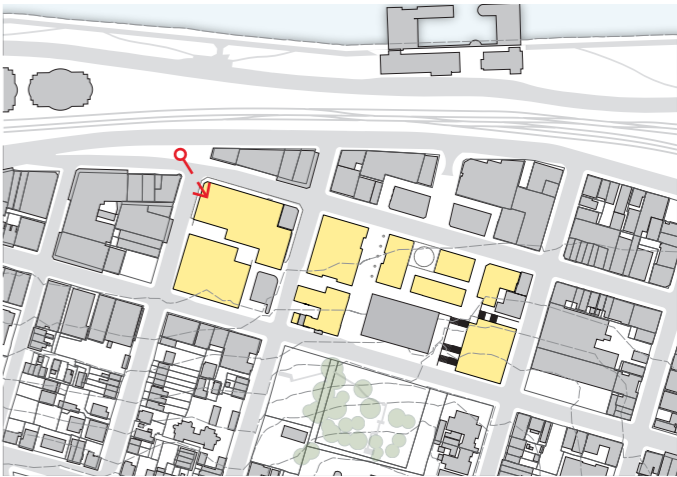

- APPROVED DA
- PROPOSED ADDITIONS TO BUILDING B

Perkins and King Street
intersection

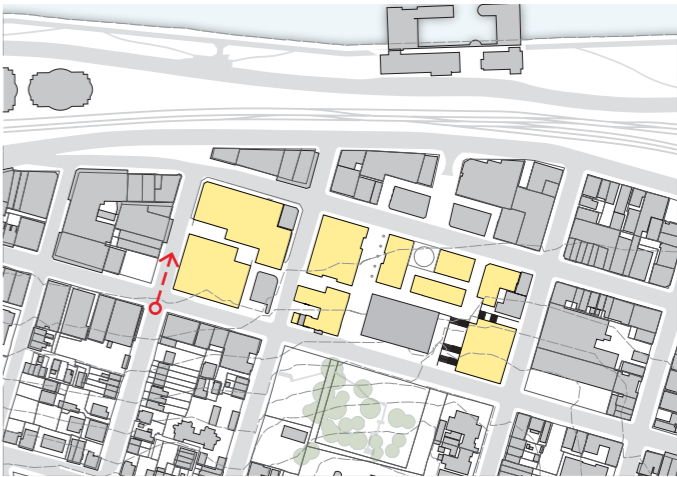

- APPROVED DA
- PROPOSED ADDITIONS TO BUILDING B

Perkins St, between Church
& King St facing North

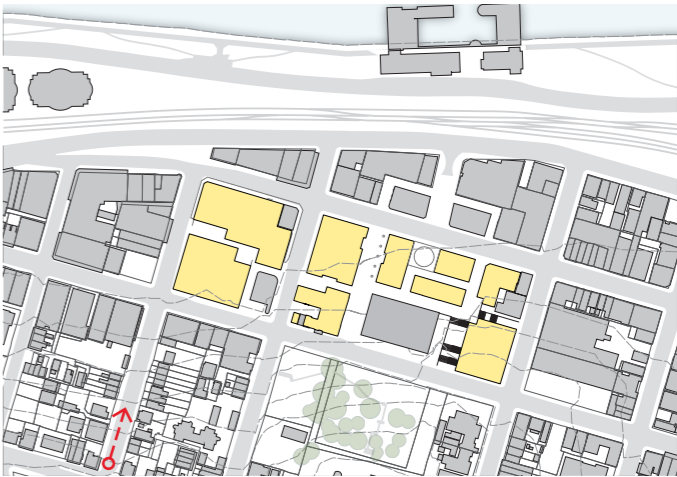

- APPROVED DA
- PROPOSED ADDITIONS TO BUILDING B

View from cathedral Park

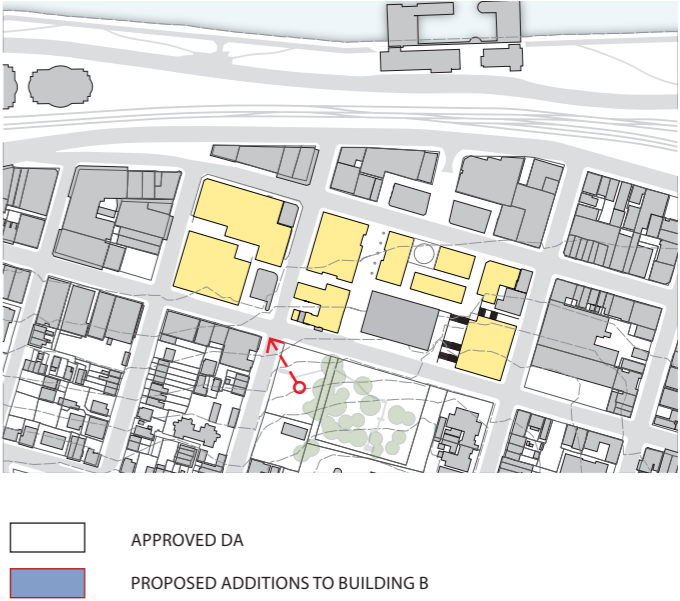

View from cathedral Park

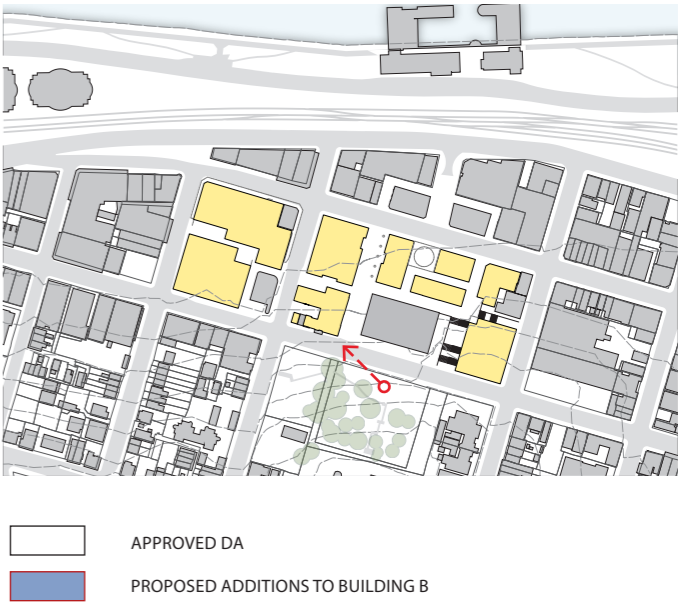

View from cathedral to Throsby Basin

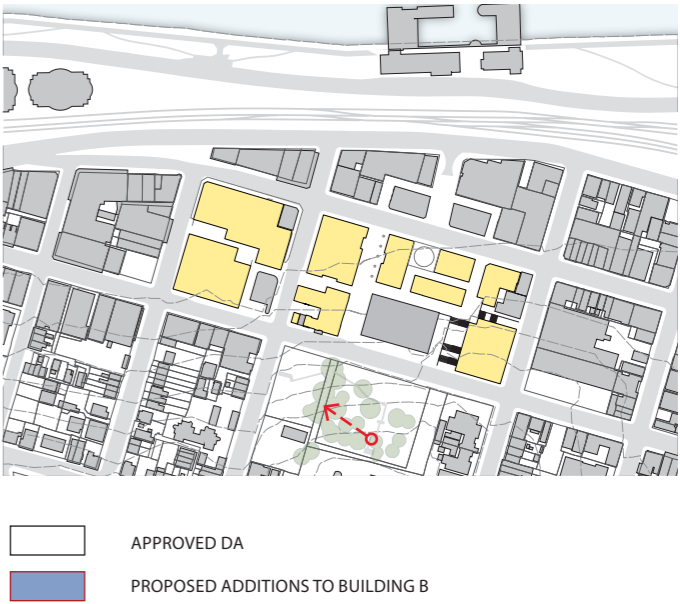

Griffith Park, Stockton

